

Technical Data Sheet

| No. | Description | Code | Fixings Included |
|-----|-----------------------------|--|------------------|
| 1 | 500/ 600 Slim/ STD BTW Unit | T3BW5C.X/ T2BW5C.X T3BW5L.X/ T2BW5L.X T3BW6C.X/ T2BW6C.X T3BW6L.X/ T2BW6L.X | YES |

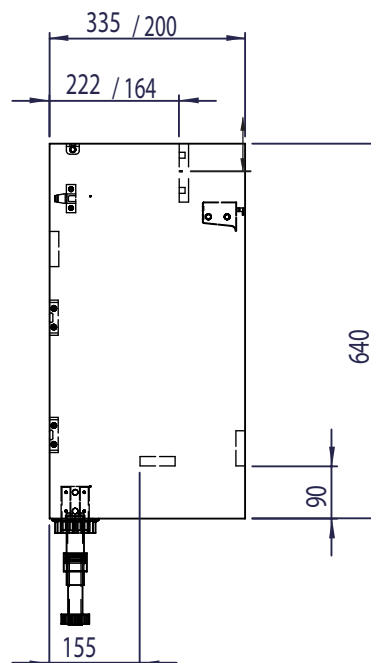
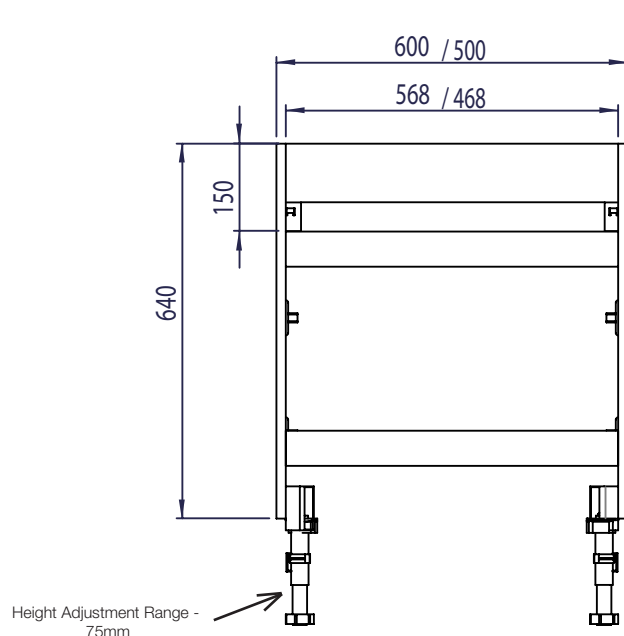

Diagrams not to scale
All dimensions in mm
tolerance of +/-2mm

Materials

Carcass: 16mm MFC (Melamine Faced Chipboard)

*Dimensions are subject to change, customers are advised to measure actual product before commencing installation.

**Fixing point dimensions are for guidance only/the positions of wall fixing must be checked when product is received.

FAQs

Q: How do I fix the unit to the wall?

A: It is highly recommended to secure the unit to the wall drilling through the back brace./There are adjustable wall hangers installed in the unit and wall plate kit provided.

Q: Are the fascia/ door packs included

A: No, these will need to be ordered separately - see brochure for reference

Q: Are the BTW fascia and cupboard fascia interchangeable?

A: No.

Q: Should I see the carcass behind the fascia components?

A: Yes, parts of the carcass may be visible when installed.

NOTE: Colours unique to Roper Rhodes - No RAL Code available

Technical Data Sheet

| No. | Description | Code | Fixings Included |
|-----|--|--|------------------|
| 1 | 500/ 600/ 700 SCT STD/ Slim Carcass Unit | T3SC5C.X/ T2SC5C.X T3SC5L.X/ T2SC5L.X T3SC6C.X/ T2SC6C.X T3SC6L.X/ T2SC6L.X | YES |

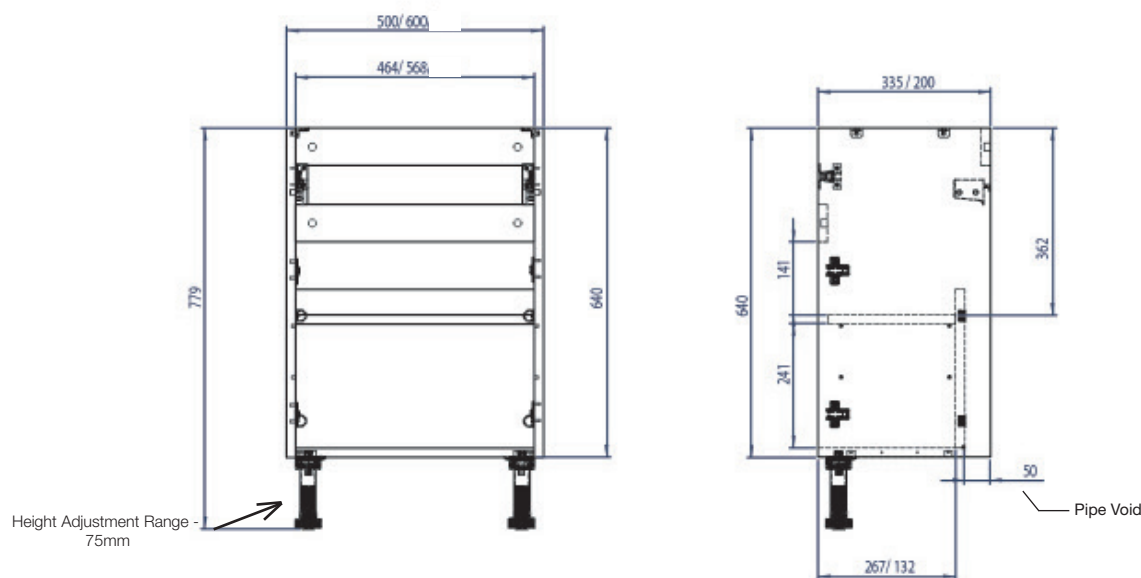

Diagrams not to scale
All dimensions in mm
tolerance of +/-2mm

Materials

Carcass: 16mm MFC (Melamine Faced Chipboard)

*Dimensions are subject to change, customers are advised to measure actual product before commencing installation.
**Fixing point dimensions are for guidance only/the positions of wall fixing must be checked when product is received.

FAQs

Q: How do I fix the unit to the wall?

A: It is highly recommended to secure it to the wall drilling through the back brace./There are adjustable wall hangers installed in the unit and wall plates kit is provided.

Q: Are the fascia/ door packs included

A: No, these will need to be ordered separately - see brochure for reference

Q: When the doors are open, what's the depth of the unit?

| Carcass Size | STD | SLIM |
|--------------|-------|-------|
| 500mm | 581mm | 446mm |
| 600mm | 631mm | 496mm |

Dimensions are Approx

Q: What is the opening Angle?

A: 90 Degrees

Q: What material is the shelf?

A: 16mm MFC, Held in position with shelf pins. Shelves are adjustable at a 98mm height increment.

Q: Are the door positions reversible?

A: Yes, hinge plates can be mounted either side to allow for door reversability.

NOTE: Colours unique to Roper Rhodes - No RAL Code available

Technical Data Sheet

| No. | Description | Code | Fixings Included |
|-----|--|--|------------------|
| 1 | 200/ 300/ 400 STD/ Slim Floor Cupboard | T3FC2C.X/ T2FC2C.X T3FC2L.X/ T2FC2L.X T3FC3C.X/ T2FC3C.X T3FC3L.X/ T2FC3L.X T3FC4C.X/ T2FC4C.X T3FC4L.X/ T2FC4L.X | YES |

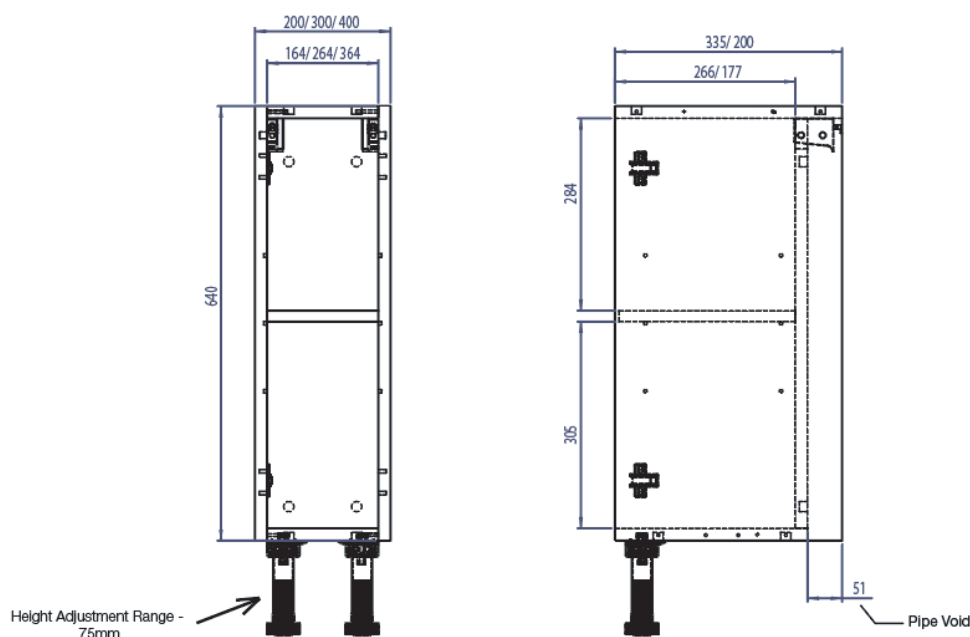

Diagrams not to scale
All dimensions in mm
tolerance of +/-2mm

Materials

Carcass: 16mm MFC (Melamine Faced Chipboard)

*Dimensions are subject to change, customers are advised to measure actual product before commencing installation.

**Fixing point dimensions are for guidance only/the positions of wall fixing must be checked when product is received.

FAQs

Q: How do I fix the unit to the wall?

A: There are adjustable wall hangers installed in the unit and wall plate kit provided.

Q: Are the fascia/ door packs included

A: No, these will need to be ordered separately - see brochure for reference

Q: When the door is open, what's the depth of the unit?

| Carcass Size | STD | SLIM |
|--------------|-------|-------|
| 200mm | 531mm | 396mm |
| 300mm | 631mm | 496mm |
| 400mm | 731mm | 596mm |

Dimensions are Approx

Q: What is the opening angle?

A: 90 Degrees

Q: What material is the shelf?

A: 16mm MFC, Held in position with shelf pins. Shelves are adjustable at a 98mm height increment.

Q: Are the door positions reversible?

A: Yes, hinge plates can be mounted either side to allow for door reversability.

NOTE: Colours unique to Roper Rhodes - No RAL Code available

Technical Data Sheet

| No. | Description | Code | Fixings Included |
|-----|---------------------------|--------------------------------------|------------------|
| 1 | 300/ 600 Slim WM Cupboard | TWC3C.X/ TWC3L.X TWC6C.X/ TWC6L.X | YES |

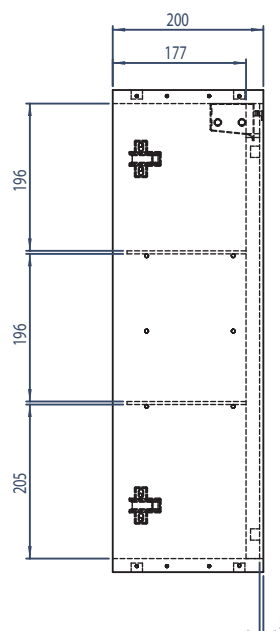
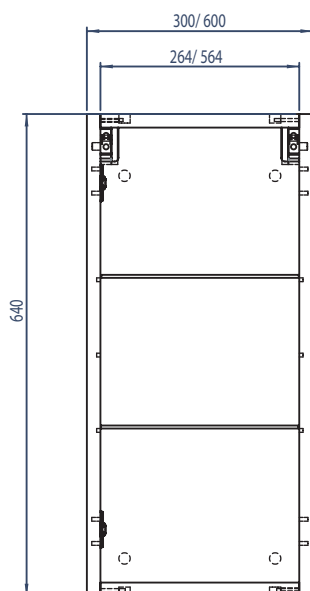

Diagrams not to scale
All dimensions in mm
tolerance of +/-2mm

Materials

Carcass: 16mm MFC (Melamine Faced Chipboard)

*Dimensions are subject to change, customers are advised to measure actual product before commencing installation.

**Fixing point dimensions are for guidance only/the positions of wall fixing must be checked when product is received.

FAQs

Q: How do I fix the unit to the wall?

A: There are adjustable wall hangers installed in the unit and wall plate kit provided.

Q: How much space is available at back of unit?

A: Sufficient spacing to suit Camar slim type cabinet hanger system. Hanger system can pull unit closer to wall, move left to right and up or down.

Q: When door open, what's the depth of the unit?

| Carcass Size | SLIM |
|--------------|-------|
| 300mm | 496mm |
| 600mm | 496mm |

Dimensions are Approx

Q: What is the opening angle?

A: 90 Degrees

Q: What material is the shelf?

A: 4mm THK toughened glass shelf - Held in position with shelf pins. Shelves are adjustable at a 98mm height increment.

Q: Are the door positions reversible?

A: Yes, hinge plates can be mounted either side to allow for door reversability.

NOTE: Colours unique to Roper Rhodes - No RAL Code available

Technical Data Sheet

| No. | Description | Code | Fixings Included |
|-----|--|--------------------|------------------|
| 1 | 300mm STD Full Height Twin Door Cupboard | T3FH3C.X/ T3FH3L.X | YES |

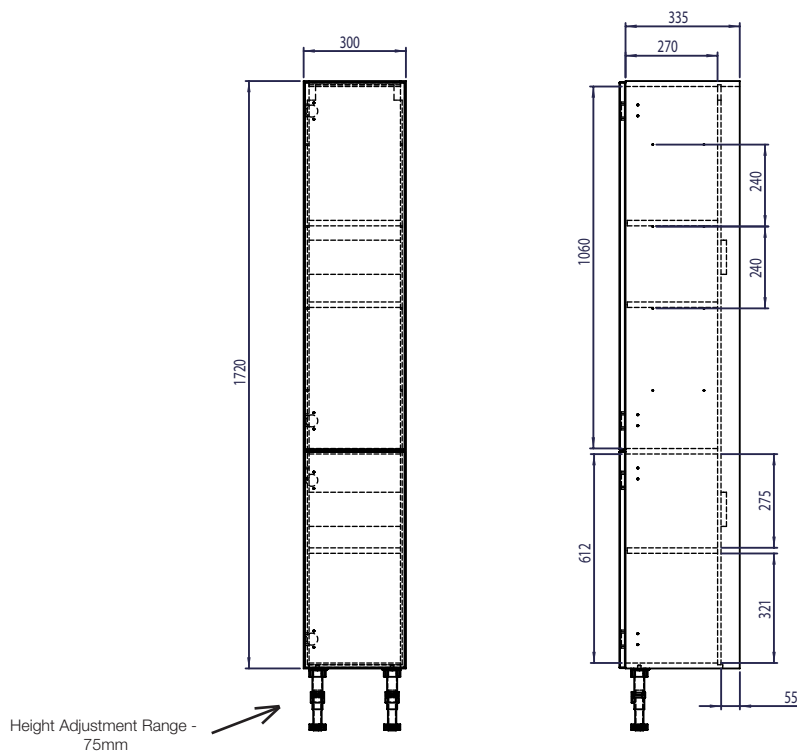

Diagrams not to scale
All dimensions in mm
tolerance of +/-2mm

Materials

Carcass: 16mm MFC (Melamine Faced Chipboard)

*Dimensions are subject to change, customers are advised to measure actual product before commencing installation.

**Fixing point dimensions are for guidance only/the positions of wall fixing must be checked when product is received.

FAQs

- | | |
|---|--|
| Q: How do I fix the unit to the wall? | A: There are adjustable wall hangers installed in the unit and wall plate kit is provided. |
| Q: Are the fascia/ door packs included | A: No, these will need to be ordered separately - see brochure for reference |
| Q: Is the shelf removable? | A: There is one fixed shelf in the bottom cupboard and two adjustable glass shelves in the top cupboard. |
| Q: When the doors are open, how wide is the unit? | A: Approx 635mm. |
| Q: Are the door positions reversable? | A: Yes, hinge plates can be mounted either side to allow for door reversability. |

NOTE: Colours unique to Roper Rhodes - No RAL Code available

Technical Data Sheet

| No. | Description | Code | Fixings Included |
|-----|---|--------------------|------------------|
| 1 | 300mm Slim Full Height Twin Door Cupboard | T2FH3C.X/ T2FH3L.X | YES |

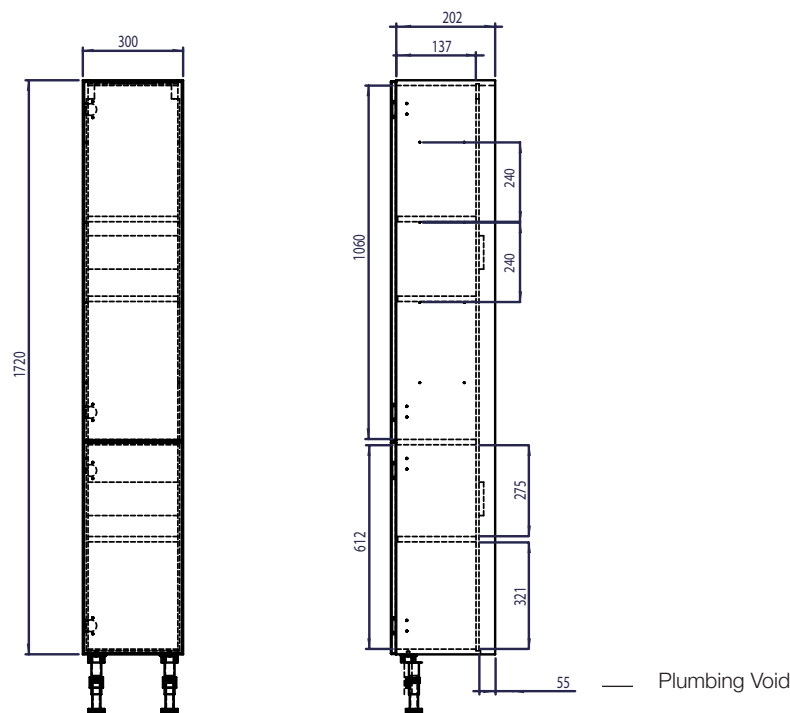

Diagrams not to scale
All dimensions in mm
tolerance of +/-2mm

Materials

Carcass: 16mm MFC (Melamine Faced Chipboard)

*Dimensions are subject to change, customers are advised to measure actual product before commencing installation.
**Fixing point dimensions are for guidance only/the positions of wall fixing must be checked when product is received.

FAQs

| | |
|---|--|
| Q: How do I fix the unit to the wall? | A: There are adjustable wall hangers installed in the unit and wall plate kit is provided. |
| Q: Are the fascia/ door packs included | A: No, these will need to be ordered separately - For Reference: Top Fascia - 1077mm x 296mm / Bottom Fascia - 635mm x 296mm |
| Q: Is the shelf removable? | A: Yes, You can reposition the glass shelves. The shelf depth is 137mm. Shelves are adjustable at 98mm increments. |
| Q: When the door is open, how deep is the unit? | A: The unit with the door open is approx. 327mm. |
| Q: Are the door positions reversible? | A: Yes, hinge plates can be mounted either side to allow for door reversability. |

NOTE: Colours unique to Roper Rhodes - No RAL Code available